



# IntelliCOMM™

## REMOTE COMMANDER



IntelliCOMM™  
Remote Commander

### IntelliCOMM™

#### Remote Commander

delivers a stable, software defined, cost effective station alerting system which Fire, Rescue, and Emergency services can depend on 24/7.

### The IntelliCOMM™

#### Remote Commander

is a Next Generation remote station alert system, with secure Internet protocol activation.





# What does IntelliCOMM™ offer?



## **Station Management, Command and Control**

- Emergency dispatch & response time is reduced.
- Seamless integration with existing CAD systems.
- Improves compliance with the SANS 10090 codes.
- Stable, low maintenance cost effective and minimal infrastructural impact.
- Integrates with existing electrical and PA infrastructure.
- Accessible local partner support network.



## **Emergency Services Dispatchers and Responders**

- Fastest possible emergency dispatch alert possible via Internet
- Dependable, visual and audio alert command.
- Improved rapid response time and efficiency.
- Increases incident turn around rates.
- Ascending bells helps to reduce stress during alerting process.
- Streamlines the emergency dispatching process



## **Emergency Services IT Professionals**

- Low maintenance hardware appliance.
- Accessible HTTP/s control protocol with proven system uptime.
- Scalable, software defined operation, customisable to client specifications.
- Multi-protocol support including all L2 and L3 Internet Standard Protocols (ISP).
- Reduces service callouts through full remote configuration capabilities.



## **For the Community**

- Quicker emergency service response and increased service delivery.
- Saves lives and property.
- Aligned with global emergency services best practice.
- Improved community and emergency sector relations.
- An opportunity to rebuild trust in, and respect for, emergency services.



# Fire Station Alerting System



The **IntelliCOMM™ Remote Commander** has been developed to activate with one command from the Emergency Control Centre/ Call-taking And Dispatch system. The customisable firmware automatically activates all the relevant alerting elements such as lights, bells, sirens, gates to alert the remote station to an Emergency Callout Situation. All elements in the system goes off in a predetermined sequence thereby reducing any potential failed emergency calls due to any unreliable network connections. A local manual override provides failsafe activations from the station watch room.

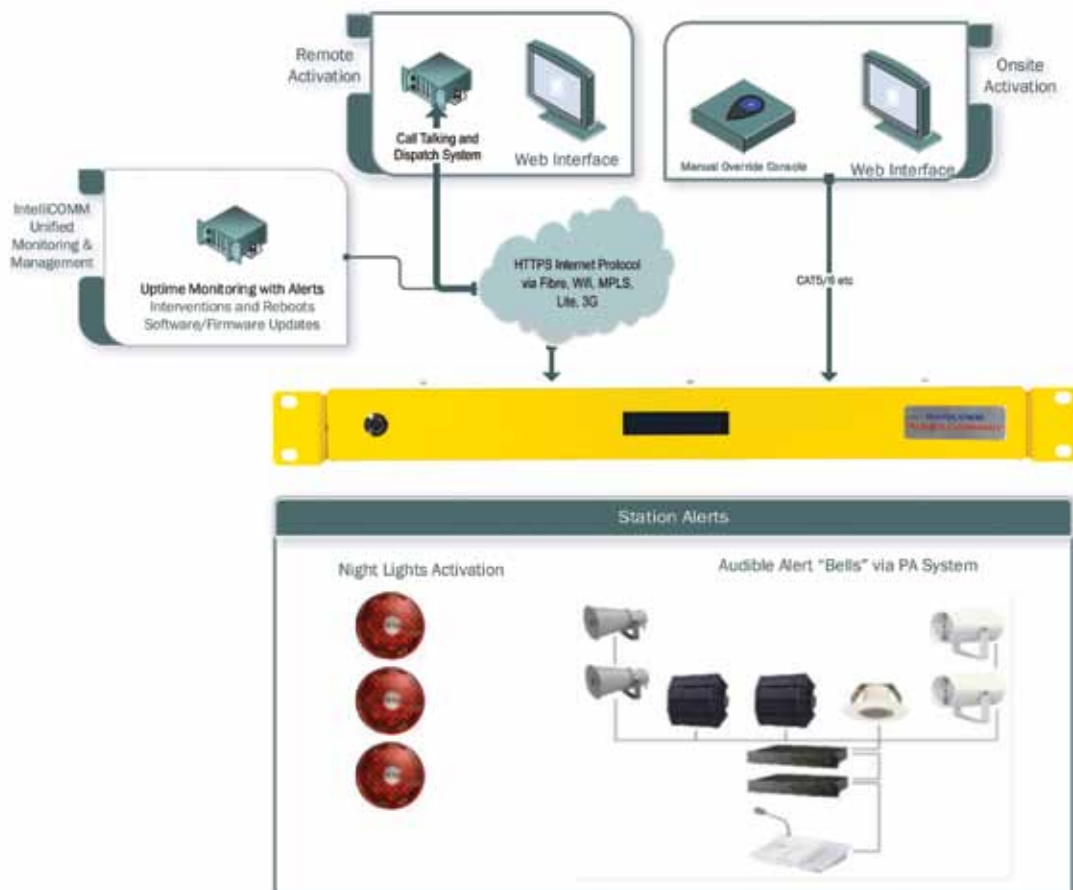



# Features & Specifications

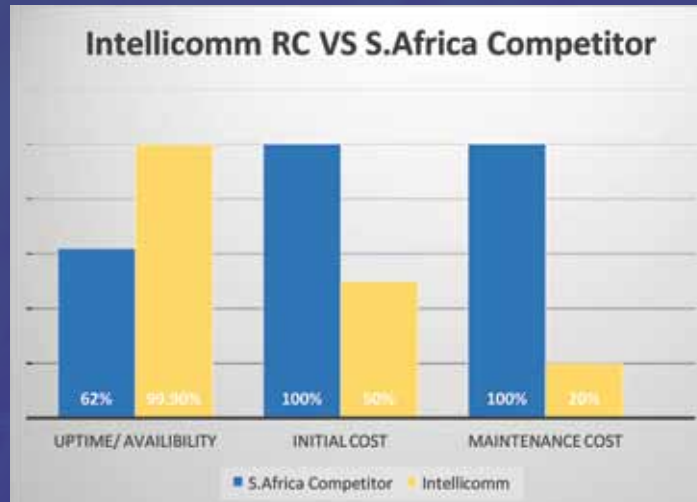

## IntelliCOMM™ Remote Commander Specifications:

- 4 x remote controllable , optically isolated power outputs (max 220v 2200w/4) at the same voltage as the controllable power input
- Normally Open or Normally Closed relays
- Independent 120/220v system power
- Networking: Gbe Network Interface, 2.4Ghz WiFi
- Remote management via Remote Uptime Monitoring and Management Appliance
- Backlit LCD showing current operation and system status
- Remote management via Remote Uptime Monitoring and Management Appliance

## IntelliCOMM™ Remote Commander Features:

- Full TCP/IP stack with VPN capability
- Fully customisable software environment
- Easy HTTP API for interfacing with CAD/ eOB/Incident Management software
- 5 hours of firmware customisation included per site
- Quality construction for long life span
- Audio PA pass through for sirens/bells and Roger Bleep injection



Made in Cape Town, South Africa by TABITS cc

**Website:**  
[www.intellicomm.net.za](http://www.intellicomm.net.za)

**Email:**  
[info@intellicomm.net.za](mailto:info@intellicomm.net.za)

Distributed by

